



GENESIS ARMS MTW GEN-12 SHOTGUN OWNER'S MANUAL

WOLVERINE AIRSOFT

www.wolverineairsoft.com

Table of Contents

Important Safety Information	3
Getting to Know your Gen-12 MTW Shotgun	4
Getting Started	5
General Use	
Reloading a Magazine	6
Unloading	6
Hop-Up Adjustment	7
Empty Magazine Detection	7
Fire Mode Selection	7
Stock Adjustment/Removal	8
Using a Chronograph	9
Disassembly	10
HAVOC HPA Engine Maintenance	12
Reassembly	14
Additional Documentation	16

Don't Forget to Register Your Warranty!

Your MTW is backed by Wolverine Airsoft's limited warranty. Scan the QR code or visit www.wolverineairsoft.com/warranty to read our full warranty and register your MTW.



Important Safety Information



Always wear safety goggles when using your Airsoft gun.
Portez toujours des lunettes de protection lorsque vous utilisez votre réplique. Utilisez siempre gafas protectoras cuando emplee su réplica.



Select a safe place for operating the Airsoft gun. Avoid shooting in public places.
Choisissez un endroit sûr pour utiliser votre réplique à billes, évitez les endroits publics. Escoga un lugar seguro para disparar la réplica. Evite lugares públicos.



Do not look directly into the gun barrel. Ne regardez pas directement dans le canon de votre réplique. No mire directamente hacia el canon de las réplicas.



Never shoot holding the Airsoft gun side-ways as the BB pellets will curve (this is due to the hop-up system). Ne tenez jamais la réplique de travers. Les billes peuvent partir à droite ou gauche. (Cela est dû au système de Hop-up). Jamais agarrar y disparar la réplica horizontalement, por el sistema hop-up los proyectiles BB podrán cambiar de dirección en el aire.



Never aim or shoot at people or animals. Always set the selector on "safe" position [except when you are ready to shoot a target]. Ne visez et ne tirez jamais sur une personne ou un animal. Veuillez régler le sélecteur sur la position sécurisée [excepté lorsque vous êtes prêt à tirer sur votre cible]. Nunca apunte o dispare hacia personas o animales. Mantenga siempre el seguro en las posición "safe" hasta que este listo para disparar al blanco.



Do not disassemble gun yourself. Always contact your local retailer. Ne jamais démonter ou modifier votre réplique. Veuillez contacter votre revendeur d'airsoft pour toute question. No desarme la réplica usted mismo. Póngase siempre en contacto con el revendedor local.

Proper handling of your replica is critical to the safety and well being of yourself and those around you. When in doubt follow the Four Rules of Gun Safety:

1. Always treat every gun as if it was loaded.
2. Never point a gun at something you are not willing to destroy.
3. Keep your finger off the trigger until you have the weapon pointed at your target and are ready to shoot.
4. Be aware of the backdrop of your target. (i.e. what is behind your target in case you miss or the projectile over-penetrates).

Every day our rights continue to be restricted because people are irresponsible and abuse them. Please be part of the solution, not the problem. Learn your local laws, how your equipment works, how to use it safely, and always exercise responsibility.

Always treat the airsoft gun as if it were loaded. Do not carry the airsoft gun in open view. Always transport the airsoft gun unloaded in a locked case. Do not openly brandish the airsoft gun, as this may be perceived by others [including law enforcement units] as a threat, and cause prompt reaction. Always use precision 6mm BBs for this airsoft gun. Never use any used or damaged BBs.

Manipulez toujours votre réplique comme si elle était chargée. Ne pas porter cette réplique sur vous en public. Transportez toujours la réplique déchargée, dans une mallette verrouillée. Ne pas ouvertement brandir votre réplique, car cela peut être perçu par d'autres (y compris les unités de police) comme une menace, et provoquer des troubles à l'ordre public. Veuillez toujours utiliser des billes de précision avec votre réplique à billes 6mm. N'utilisez jamais de billes déjà utilisées.

Siempre trate la réplica como si estuviera cargada. No lleve la réplica en vista pública. Transporte la réplica descargada, en una funda cerrada. No blandir la réplica abiertamente, ya que esto puede ser percibido por otras personas [incluso unidades de la policía] como una amenaza, y provocar una reacción instantánea. Utilice siempre BBs 6mm para su réplica. Nunca utilice BBs desperdiciados o dañados.

Getting to Know your Gen-12 MTW Shotgun

Your MTW is a precise instrument containing many individual components. Before you begin, please see the diagram below and familiarize yourself with each component. Your MTW may come with different components than pictured.

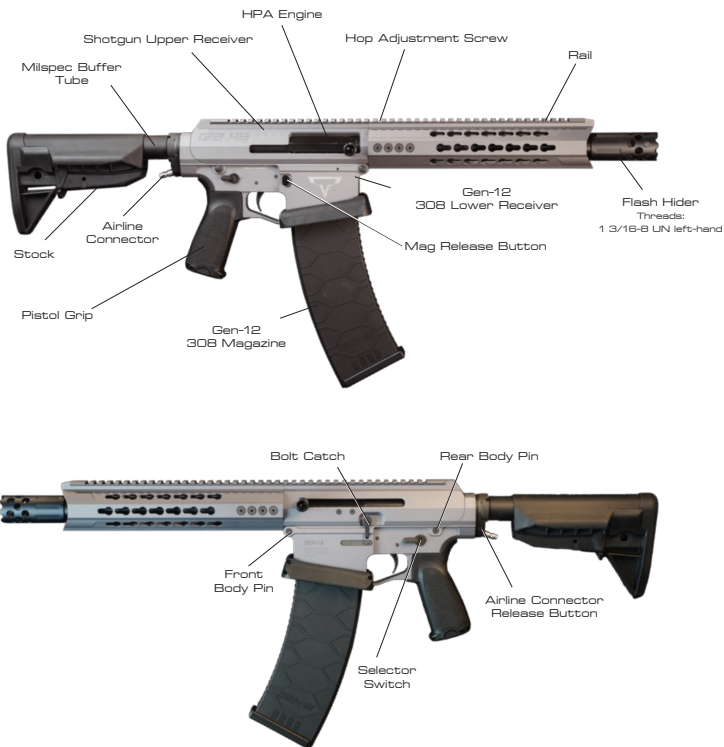

IMPORTANT!!!

Your MTW contains steel components and is susceptible to surface rusting when exposed to moisture. If your MTW is exposed to liquids, be sure to dry it thoroughly and clean the surface with a silicone-based oil.

Getting Started

Items You will need

- 7.4 LiPo battery which will fit inside the MTW buffer tube. Most batteries in the 250-500 mAh range will work.
- Charged HPA tank.
- STORM regulator or airsoft regulator in the 80-140 PSI range.
- Flex line with Foster spec fittings (standard in US airsoft market)

Attach the charging handles

Screw the included charging handles clockwise into the left and right side of the mock bolt carrier group to secure them.



Connect the Battery

Squeeze the sides of the grip door to open it and reveal the JST RCY connector. Connect the LIPO battery to the connector and secure the battery inside the grip. Note that the battery will always draw current when connected, so the MTW should not be stored with the battery connected unless you are using the MTW Battery Grip (sold separately).



Connect an HPA tank

Mount your regulator to your tank and set the pressure to 100 PSI (see manufacturer's instructions). Use a flex line to connect the regulator to the Fixed Rear Airline Connector on the lower receiver. To secure the Foster fittings, pull down the collar, push the male fitting into the female and ensure the collar snaps forward.



General Use

Loading a Magazine

Press the mag release button on the Gen-12's right side to eject a magazine. The Gen-12 is designed for use with proprietary Wolverine Airsoft 308 magazines with Empty Mag Detection (EMD) which will disable firing once the magazine is empty.

Note: Using third-party magazines will disable EMD entirely.



Press the Bolt Catch!

IMPORTANT! After inserting a new magazine, press the bolt catch on the MTW's left side to reset the empty mag detection and allow firing again.



Unloading

Always make sure your MTW is not loaded after use!

Before removing your airline, ensure the feed tube, engine, and barrel are free of BBs by removing the magazine, turning the Gen-12 upside down, and firing at least two times.



Hop-Up Adjustment

The Gen-12's hop-up is built into the Havoc HPA engine and accessible through a port in the top of the rail. Use a 1/8" hex key to rotate the hop screw clockwise to increase the hop and counterclockwise to decrease the hop.



Fire Mode Selection

The selector switch can be used to toggle between available fire modes.



Empty Mag Detection [EMD] Modes

For MTWs with Spartan Electronics, you can switch between EMD Simplified and Traditional modes by holding the bolt catch and trigger for 5 seconds. In Simplified mode, there is no need to press the bolt catch after reloading a magazine.



Programming

For more information about setting your MTWs fire modes, adjusting rate of fire, setting dwell and more, see the Spartan Electronics for MTW Owner's Manual.



Stock Adjustment

The stock can be adjusted to a comfortable length by squeezing the adjustment arm and sliding the stock along the buffer tube.



Stock Removal

To remove the stock, first, squeeze the adjustment arm completely so that a tool can be pushed through the hole as shown.



With the tool through completely through the hole, press the adjustment arm completely down and then slide the stock off the buffer tube.



Using a Chronograph

To get a correct reading when using a chronograph with the HAVOC HPA Engine, only a single BB should be fired through the system.

Remove the magazine, turn the Gen-12 upside down, and fire at least two times to ensure the Gen-12 is not loaded. Then place a single BB directly into the feed tube.



Press the BB past the BB catch into the engine.



Point the Gen-12 pointing towards the ground and rotate it right side up, ensuring the BB remains forward in the engine.



Fire through the chronograph and then repeat the steps as necessary.



Disassembly

Separating the Receivers

Before disassembling the upper and lower receiver, always remove the magazine, disconnect the battery, and disconnect any air source.



Pull both body pins out while holding the receiver set together. If they are difficult to remove, use a non-marring punch to push them through from the left side.

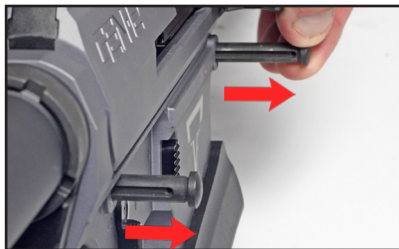

Hold the airline release button on the left side of the Fixed Rear Airline Connector (FRAC) and pull the upper receiver and airline away from the lower.



Remove the contact yoke by gently pulling up on it with your finger. Unplug it from the back of the engine by pulling on it firmly.



Remove the hop adjustment screw by turning it counterclockwise with a the 1/8" hex key, then remove the rail by removing the 8 retaining screws and pulling the rail from the upper receiver.



Note that the rail includes a detent and spring that engage the now-removed hop adjustment screw. They do not need to be removed. If they fall out, replace the spring first and then the detent. This would also be a good time to remove the nub that was retained in the upper receiver by the adjustment screw.



Remove the outer barrel base by unscrewing it counterclockwise from the receiver.



Pull the inner barrel, engine and airline assembly as one unit through the front of the receiver.

See Page 14 for information on the HAVOC HPA Engine.



Reassembly

Plug the contact yoke into the solenoid in the HAVOC HPA Engine and install the wire guide onto the engine. Align the cutaway in the guide with the barb fitting on the airline.



Partially insert the engine assembly into the upper receiver, ensuring the hop adjustment hole faces upwards, the airline feeds out the rear of the receiver and the contact yoke feeds through the bottom of the receiver. Snap the contact yoke into the recess in the receiver as shown.



Align the hop adjustment screw holes on the engine and the receiver. Temporarily use the adjustment screw to hold the engine in place while screwing the outer barrel base into the receiver.

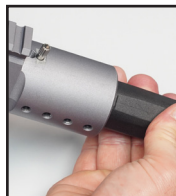

Insert the inner barrel into the chamfered end of the guide, and then slide the outer barrel over the guide and tight to the base. Note that the two O-rings are not sealing surfaces and are used to hold the outer barrel into place.

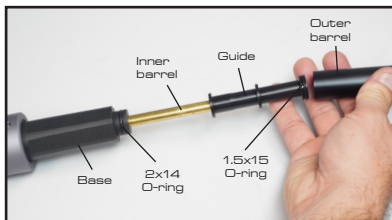

Remove the hop adjustment screw, slide the rail onto the upper receiver. Replace the nub vertically as shown and reinstall the hop adjustment screw, ensuring the spring and detent mentioned on Page 10 are engaging with the screw and clicking.

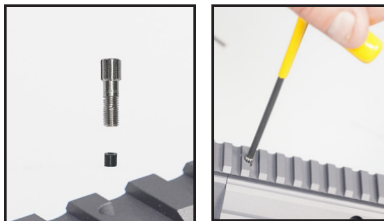

Secure the rail with the 8 retention screws using a 1/8" hex key.



Assemble the upper and lower receiver, ensuring the airline passes through the Fixed Rear Airline Connector. Hold the button to allow the airline fitting to pass through and lock in the correct position.

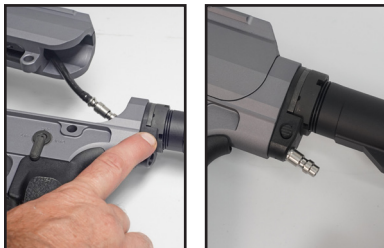

Finally, snap both body pins into place.



HAVOC HPA Engine Maintenance

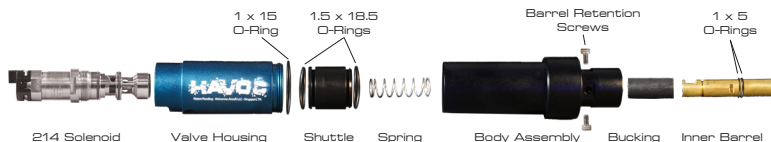

Specifications

Pressure Operation Range: 80-140 PSI

Voltage Operation Range: 6-8V

Muzzle Energy: .5J-1J per BB

ROF: 2-6 RPS

Regular maintenance on the HAVOC HPA engine should be performed every 25-50k rounds depending on the conditions it is being used in. The dustier and dirtier the conditions, the more frequently it should be serviced.

Separate the two halves of the engine by unscrewing the black cylinder housing counterclockwise from the blue valve housing.



Remove the spring and shuttle from the valve housing.



Use a lint-free cloth to clean the shuttle and O-rings. Inspect the O-rings for any damage and replace if necessary.



Lubricate the exterior surface of the shuttle including the O-rings, being sure to cover all sides.



Reinstall the shuttle and spring as shown.

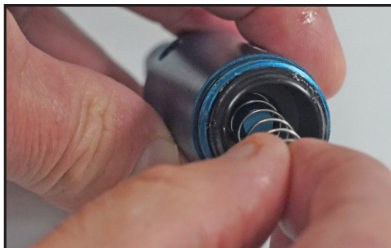

Screw the valve housing clockwise into the cylinder and hand-tighten.



Additional Documentation

Please see the separate Owner's Manuals below for more information on your electronics.



[Spartan](#)
[Electronics](#)

Need more help?

Check out the Wolverine Airsoft Knowledgebase for articles, videos, maintenance guides, and more!

<http://www.wolverineairsoft.com/knowledgebase>.



**Need professional
help?**

To find a retailer close to you visit:
www.wolverineairsoft.com/dealers



www.wolverineairsoft.com