

GEN-12 MTW SHOTGUN

QUICK START GUIDE

ITEMS YOU WILL NEED

- 7.4 LiPo battery which will fit inside the grip.
Most batteries in the 250-500 mAh range will work.
- Charged HPA tank.
- STORM regulator or airsoft regulator in the 80-140 PSI range.
- Flex line with Foster spec fittings (standard in US airsoft market)
- BBs (Recommended weight of 0.28g or higher).

Attach the charging handles

Screw the included charging handles clockwise into the left and right side of the mock bolt carrier group to secure them.



Connect the battery

Squeeze the sides of the grip door to open it and reveal the JST RCY connector. Connect the LIPO battery to the connector and secure the battery inside the grip. Note that the battery will always draw current when connected, so the MTW should not be stored with the battery connected.



Connect an HPA tank

Mount your regulator to your tank and set the pressure to 100 PSI [see manufacturer's instructions]. Use a flex line to connect the regulator to the Fixed Rear Airline Connector on the lower receiver.



Press the bolt catch!

Each time you insert a new magazine, press the bolt catch on the MTW's left side to reset the empty mag detection and allow firing again.



Disassembly

Remove the magazine, disconnect the battery, and disconnect any air source. Pull both body pins out while holding the receiver set together. If they are difficult to remove, use a non-marring punch to push them through from the left side.

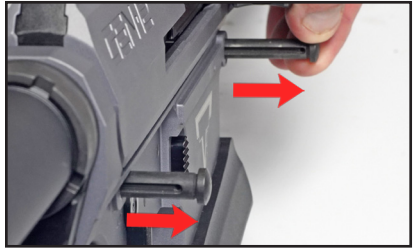

Hold the airline release button on the left side of the Fixed Rear Airline Connector (FRAC) and pull the upper receiver and airline away from the lower.



Reassembly

Begin assembly by feeding the airline through the Fixed Rear Airline Connector. Hold the button to allow the airline fitting to pass through and lock in the correct position.



Align the front and rear lugs and snap both body pins into place.



Please read the full owner's manual including safety warnings before use. Scan the QR code or visit www.wolverineairsoft.com/documentation

