



WRAITH

AERO/PDW

OWNER'S MANUAL



WOLVERINE AIRSOFT

www.wolverineairsoft.com

Table of Contents

Important Safety Notices	3
Getting Started	4
Installation	5
General Use	7
Maintenance	8

Don't Forget to Register Your Warranty!

Your WRAITH Aero or PDW is backed by Wolverine Airsoft's limited warranty. Scan the QR code or visit www.wolverineairsoft.com/warranty to read our full warranty and register your WRAITH Aero or PDW.



Important Safety Notices

High pressure air systems contain air compressed under great pressure and should always be treated with care to avoid serious injury or death. Always be sure that your tank and tank regulator is in good working order before use with the Wolverine Airsoft STORM regulator.

In particular, ensure that all threaded components of the tank regulator are properly torqued to avoid all or part of the tank regulator from unscrewing from the tank during disassembly of the STORM regulator from the tank. Please consult a paintball or airsoft professional tech if you have any questions regarding the safe servicing of your tank.

Never leave HPA or CO2 tanks in direct sunlight [including during play], in parked cars, or otherwise submit them to excessive heat. Heat will cause an unsafe rise in pressure in the tank which could lead to serious injury or death.

When using CO2 always be sure to have the tank securely mounted vertically on your body. Allowing the CO2 tank to partially or fully invert will result in liquid CO2 being sucked into the gun which can result in an unsafe spike in pressure/velocity and could damage your Wolverine Airsoft engine.

Getting Started

WRAITH Aero and WRAITH PDW are intended for use only with the Wolverine Airsoft MTW and with standard pressure or low pressure paintball HPA tanks, 12gram CO2 cartridges or 33g CO2 cartridges. Pressure is adjusted by turning the set screw on the top of the regulator using the included 3/32" hex key.

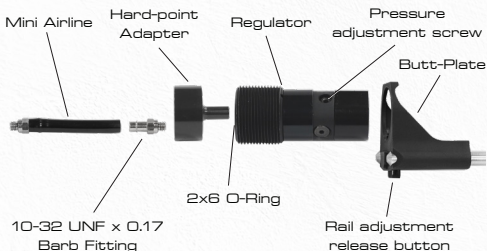

Specifications

Pressure adjustment Range: 40-140 PSIG
Input Pressure Range: 300-1000 PSIG
Pressure Adjustment Rate: ~15 PSI/Turn
Recommended Service Time: 100,000 shots or every 6 months

Installation

First, separate the MTW upper and lower receivers. Then, remove the stock and buffer tube by loosening the castle nut and rotating the stock counter-clockwise. Be sure not to lose the detent and spring.



Screw the regulator into the receiver all the way until the front of the regulator is flush with the inside of the receiver and then ensure the index groove is facing down. If the spring and detent came out during disassembly, be sure they are replaced.



Slide the butt plate around the regulator, making sure the spring is not bent or pinched. Secure the butt-plate to the receiver with the castle nut. You may wish to use a small hammer and punch to ensure the castle nut is tightened completely.



Remove the engine from the upper receiver by first removing the contact yoke and unplugging it from the engine, and then removing the feed tube assembly.

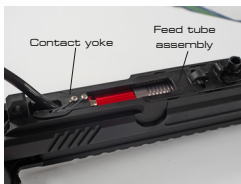

Remove the standard air line from the engine and connect the mini air line that came with your Wraith stock. Then, connect the hard-point adapter into the other end of the air line.



Slide the engine back into the receiver. The hard-point adapter should stick beyond the upper receiver so that it can fit into the hole in the regulator. Secure the engine with the feed tube assembly and then reinstall and reconnect the contact yoke.



Rejoin the upper and lower receivers, ensuring the hard-point adapter fits snugly to the regulator.



Aero / HPA Tanks

The WRAITH Aero is intended for use with a standard 13/300 HPA air tank [sold separately].



PDW / CO2 Cartridges

The WRAITH PDW is intended for use with a WRAITH CO2 12gram Adapter or WRAITH CO2 33gram Adapter [sold separately] and standard CO2 tanks.

**CO2 Adapter
33g Edition**



**CO2 Adapter
12g Edition**



Install cartridges with intentionality. Once the puncture pin penetrates the cartridge, make sure they are secured in place by either screwing the 33gram cartridge in tightly or ensuring the quick-change cap is completely locked in place by the safety catches on the CO2 holder. Never attempt to remove cartridges until they are empty.

Puncture Pin Adjustment

The WRAITH CO2 Adapter 12gram Edition quick-change mechanism is adjustable to fit differences in brands of CO2 cartridges on the market.

To set for proper engagement, loosen the lock-ring that sits between the CO2 holder and expansion chamber. Turn the CO2 holder counter-clockwise until the quick-change cap can be fully installed without putting any force on the cartridge.

With cap in the installed position rotate cap and CO2 holder clockwise firmly until CO2 cartridge punctures and seals. Then, tighten the lock-ring to secure the CO2 holder to the expansion chamber. The engagement should now be properly set.

Tuning

Adjust the pressure on the tank by using the included 3/32 hex key to turn the small set screw on the front of the regulator.



Maintenance

Your WRAITH regulator is designed to require very little maintenance. However if you feel the regulator is in need of lubrication you can disassemble by removing the three flat head screws from the side of the regulator. Use Techt Gun Sav or another O-ring safe lubricant on all o-rings and reassemble.

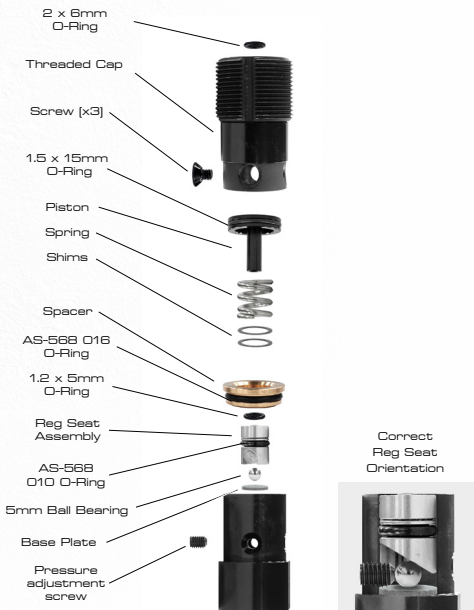

Need professional help?

To find a retailer close to you visit:
www.wolverineairsoft.com/dealers



www.wolverineairsoft.com