

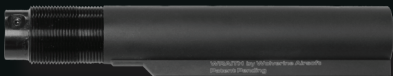

# **WRAITH**

**CO2 Stock**



**WOLVERINE AIRSOFT**

[www.wolverineairsoft.com](http://www.wolverineairsoft.com)

## **Welcome to the Wolverine Airsoft HPA Family!**

Your WRAITH CO2 Stock comes with following contents in the package. Please ensure that all components of the package are present and undamaged.

### **All packages contain:**

- WRAITH CO2 Stock
- Mini Airline
- 1/8" Allen wrench
- 3/32" Allen wrench
- 33g spanner wrench or 12g hook wrench
- O-Ring Kit
- WRAITH Patch

### **These kits also contain:**

#### **MTW Kit**

- Hardpoint Adapter
- Grip Base Plate
- Hard Stop
- Airline Fitting

#### **AEG Kits**

- Castle Nut
- Buffer Tube Nut
- Washer
- Screw

## Table of Contents

Important Safety Notices	4
Getting Started	5
MTW Installation	6
General Use	8
Maintenance	10

---

## Don't Forget to Register Your Warranty!

Your WRAITH CO2 Stock is backed by Wolverine Airsoft's limited warranty. Scan the QR code or visit [www.wolverineairsoft.com/warranty](http://www.wolverineairsoft.com/warranty) to read our full warranty and register your WRAITH CO2 Stock.



## Important Safety Notices

High pressure air systems contain air compressed under great pressure and should always be treated with care to avoid serious injury or death. Never leave HPA or CO<sub>2</sub> tanks in direct sunlight (including during play), in parked cars, or otherwise submit them to excessive heat. Heat will cause an unsafe rise in pressure in the tank which could lead to serious injury or death.

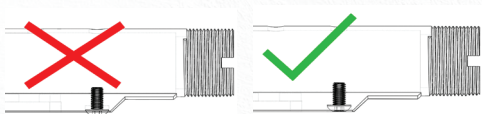

The retention screw on the Wraith CO<sub>2</sub> stock must be fully tightened and sitting below the surface of the buffer tube. DO NOT pressurize the system if the retention screw is sitting above the surface of the buffer tube as it may lead to an unsafe condition. Please see user manual for complete instructions and safety information.

If quick change mechanism parts are damaged do not continue use. Contact Wolverine Airsoft for replacement parts. Using parts when damaged may lead to a dangerous situation.

Use of the WRAITH CO<sub>2</sub> stock may void your non Wolverine Airsoft HPA system warranty. Check with the manufacturer.

## Getting Started

Your WRAITH CO2 STOCK is a precise instrument containing many individual components. Before you begin, please see the diagram below and familiarize yourself with each component.

### MTW Version



### AEG Version



### 12g Version



### 33g Version



## Specifications

Pressure adjustment Range:  
 40-140 PSI 12g version, 60-160 PSI 33g version  
 Pressure Adjustment Rate: ~15 PSI/Turn  
 Recommended Service Time: 100,000 shots  
 or every 6 months

## MTW Installation

First, separate the MTW upper and lower receivers. Then, remove the stock and buffer tube by loosening the castle nut and rotating the stock counter-clockwise. Be sure not to lose the detent and spring.



Screw the CO2 Stock into the receiver all the way until the front of the buffer tube is flush with the inside of the receiver and then ensure the index groove is facing down. If the spring and detent came out during disassembly, be sure they are replaced.



Secure the sling plate to the receiver with the castle nut. You may wish to use an armorer's wrench or a small hammer and punch to ensure the castle nut is tightened completely.



Remove the engine from the upper receiver. You may need to first remove the contact yoke and unplug it from the engine if applicable. Then removing the feed tube assembly and engine.

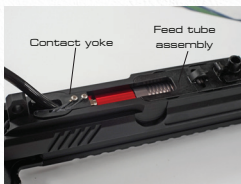

Remove the standard air line from the engine and connect the mini air line that came with your Wraith CO2 Stock. Then, connect the hard-point adapter into the other end of the air line. Tighten both fittings with a 1/4" wrench.



Slide the engine back into the receiver. The hard-point adapter should stick beyond the upper receiver so that it can fit into the hole in the regulator. Reconnect the contact yoke and then reinstall the engine with the feed tube assembly and contact yoke.



Lubricate the hardpoint adapter and rejoin the upper and lower receivers, ensuring the hard-point adapter fits snugly to the regulator.



## AEG Installation

Installation of the WRAITH CO2 stock requires permanent modification to the gun being installed and should only be undertaken by a qualified technician. Wolverine Airsoft is not responsible for damage to the airsoft gun or HPA system being used with the Wolverine Airsoft Wraith CO2 stock. For more information and videos on the WRAITH CO2 Stock, visit [www.wolverineairsoft.com/knowledgebase](http://www.wolverineairsoft.com/knowledgebase).



## General Use

Depending on your model, the WRAITH CO2 Stock is designed to be used with either 33g or 12g CO2 cartridges.



33g CO2 Cartridge



12g CO2 Cartridge

Install cartridges with intentionality. Once the puncture pin penetrates the cartridge, make sure they are secured in place by either screwing the 33gram cartridge in tightly or ensuring the quick-change cap is completely locked in place by the safety catches on the 12g holder. Never attempt to remove cartridges until they are empty.

## Tuning

Adjust the pressure by using the included 3/32" hex key to turn the small set screw on the front of the regulator.





## 12g Puncture Pin Adjustment

The WRAITH CO2 Stock 12gram Edition quick-change mechanism is adjustable to fit differences in brands of CO2 cartridges on the market.

First, loosen the locking screw that sits between the CO2 holder and expansion chamber.



Insert a fresh CO2 cartridge. With cap in the installed position rotate cap and CO2 holder clockwise firmly until CO2 cartridge punctures and seals. Fire gun to completely empty cartridge.



Rotate CO2 holder body counterclockwise one flat [1/6th rotation] and tighten locking screw. ALWAYS ENGAGE LOCKING SCREW ON ONE OF THE SIX FLATS on the CO2 holder body.



## Maintenance

To service the regulator and puncture pin assembly, use Techt Gun Sav or another O-ring safe lubricant on all O-rings and reassemble.

### Regulator

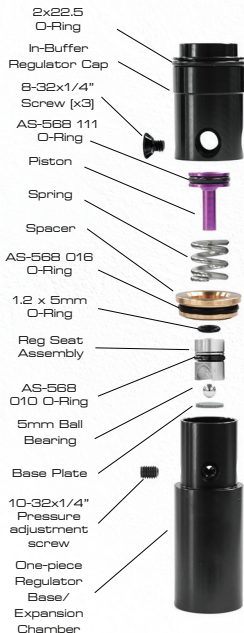

### 33g Puncture Pin Assembly



### 12g Puncture Pin Assembly

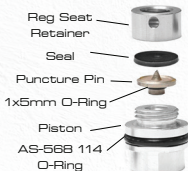

### Regulator Seat Orientation



## Disassembly

The regulator can be separated from the buffer tube by using a 1/8" Allen wrench to remove the locking screw and retention screw [12g only] from the bottom of the buffer tube.



## Puncture Pin Seal

To replace the puncture pin seal on the 12g CO2 stock, place the puncture pin assembly in a vice with soft-jaws or padding, or use a wrench and rotate the cap counterclockwise with the included hook wrench.



The 33g puncture pin assembly is glued in place and will need to be broken loose with the wide side of the included spanner wrench. Then, use the narrow side to separate the assembly. After replacing the seal, we recommend applying a small amount blue Loctite to both threads during reassembly.



## Reassembly

When inserting the regulator into the buffer tube, it is normal that the 22.5mm O-Ring will be loose. Carefully feed any slack in the O-ring into the gap below the locking screw to make it easier to insert.



Be sure to line up the threaded hole in the regulator with the large hole in the bottom of the buffer tube. Use an empty CO2 cartridge to reinstall the 33g version. Insert the retention screw and completely tighten with a 1/8" Allen wrench. Then, tighten the locking screw [12g only].



## **Need professional help?**

To find a retailer close to you visit:  
[www.wolverineairsoft.com/dealers](http://www.wolverineairsoft.com/dealers)



[www.wolverineairsoft.com](http://www.wolverineairsoft.com)