



WOLVERINE
AIRSOFT

**O-Ring and Tech Kit
Guide**



WOLVERINE AIRSOFT

www.wolverineairsoft.com

Table of Contents

INFERNO Gen 2	3
REAPER Gen 2	4
HYDRA	5
BOLT	6
BOLT M	7
STORM Category 5	8
WRAITH X	9

Full owner's manuals available at
www.wolverineairsoft.com/documentation



INFERNO Gen 2

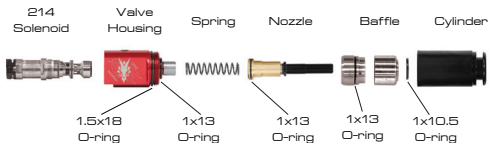

Specifications

Pressure Operation Range: 60-140 PSI
 Voltage Operation Range: 6-8V
 Muzzle Energy: .5J-3J [Setup Dependant]
 ROF: 5-35 RPS

REAPER Gen 2

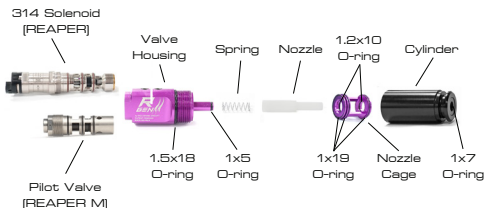

Specifications

Pressure Operation Range: 40-140 PSI
REAPER Voltage Operation Range: 6-8V
Muzzle Energy: .5J-2J [Setup Dependant]
ROF: 5-30 RPS

HYDRA

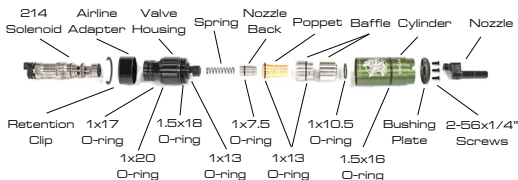

Specifications

Pressure Operation Range: 60-140 PSI
 Voltage Operation Range: 6-8V
 Muzzle Energy: .5J-3J [Setup Dependant]
 ROF: 5-35 RPS

BOLT

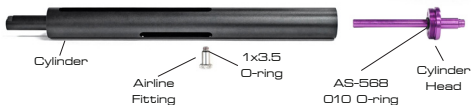
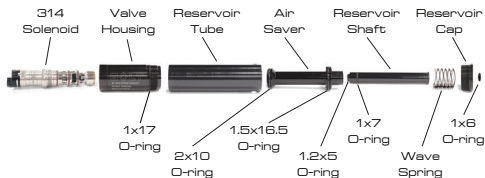

Specifications

Pressure Operation Range: 80-180 PSI
Voltage Operation Range: 6-8V
Muzzle Energy: .5J-3J [Setup Dependant]
Rate of Fire: N/A

BOLT M Started

Striker Version

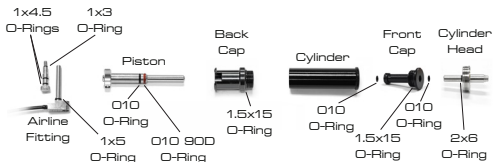

Bar 10/VSR 10 Version

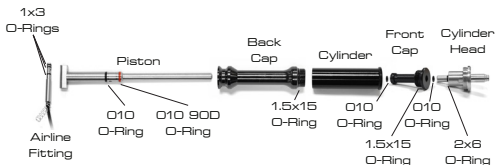

SRS Version

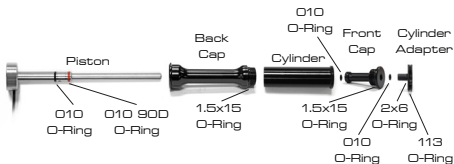

Specifications

Pressure Operation Range: 80-180 PSI

Muzzle Energy: 1-3J [Setup Dependant]

Rate of Fire: N/A

STORM Category 5

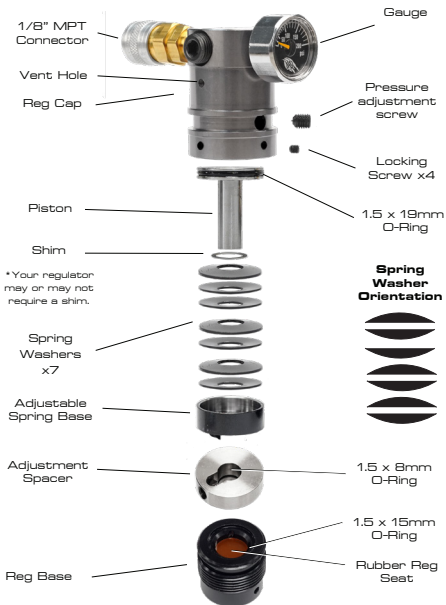

Specifications

Pressure adjustment Range: 60-180 PSIG

Input Pressure Range: 300-1000 PSIG

Pressure Adjustment Rate: ~30 PSI/Turn

Recommended Service Time: 100,000 shots or every 6 months

WRAITH X

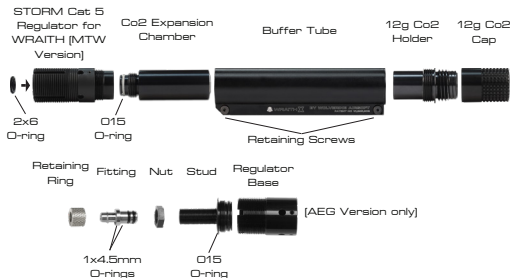

Specifications

Pressure adjustment Range: 60-180 PSI
 Recommended Service Time: 100,000 shots
 or every 6 months



www.wolverineairsoft.com